

Air . Box

(Air Quality Monitor)

User Manual

Version 1.1



AVICHE®

- Every Breath You Take Is Free -

H7 - CO₂

Device and Accessories

1. Packing List of Product

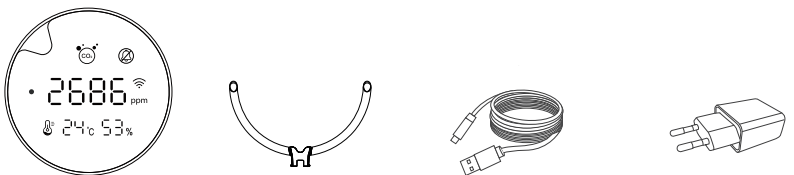

Air Quality Monitor × 1 Desktop Holder × 1 Power Cable Type-C × 1 Adapter × 1 (Optional)

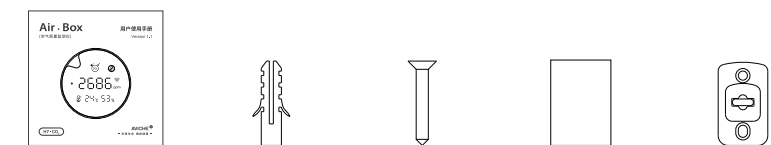

User Manual × 1 Expansion Nut × 2 Self-tapping Screws × 2 Traceless Adhesive Tap × 1 Wall Hanging Buckle × 1

Figure 1 Packing List

* Please check firstly whether the appearance of product is good and whether the variety and quantity of accessories are consistent with the packing list before installation and operation.

* Please contact the supplier or manufacturer in time in case of any defects.

Precautions for Use

- Do not expose this device to organic solvents (including silica gel, alcohol and other adhesives), water, coatings, pharmaceuticals, oils and volatile high concentrated gas.
- This device must be preheated for 5 minutes for the first time to use.**
- Do not use this device in an environment of strong air convection.
- Do not place and use this device at a extremely high temperature and humidity conditions.
- Do not place and use this device at high dust pollution environment to avoid block the ventilation components.
- Do not use this device close to electromagnetic fields to avoid the measurement data is not accurate or cause internal circuit failure.
- Do not make this device strong shocks and vibrations (such as falling from high place).
- Do not put sharp objects such as pins into the monitoring hole to avoid damaging the device components.
- If the device is not used for a long time. please kindly charge it in time to prevent the battery from being damaged by over-discharged.
- Charging the device with a power adaptor not provided by the manufacturer may cause damage to the device. It is recommended to use the original adaptor for charging.
- When the device is used to measure environmental parameters, please do not hold the device in your hands to avoid inaccurate measurement data.

▲ Special Warning:

The device cannot be used and maintained by people with mental disorders or lack of relevant experience and skills (including children) unless they are used under the custody of other safety responsible personnel or with instructions for use. During maintenance, children should be taken care of in case the device is used as toys.

Troubleshooting Guide

Trouble	Analysis	Solution
Display doesn't work	Whether the device is powered on	Long press power button to power on
	Whether the battery is over discharged	Connect power adaptor to charge
After startup, the device will automatically shut down after running for a period of time, or the screen will display after long pressing the power button, but the screen goes out when you let go	Low battery	Connect power adaptor to charge
The air quality indicator is always red and the carbon dioxide value is always high	Judge whether there is pollution in the house	Open the window ventilation
		Place the device in a ventilated place (clean air), Or stand outdoors for 1 hour, the value is still very high and needs to be opened Set the key in App and click the "QR code calibration" button to calibrate
Failed to add device during network distribution	Weak of Bluetooth signal	Adding devices using hotspot distribution networks

If the failure of the air quality monitor cannot be eliminated, please contact the supplier or manufacturer. Do not disassemble the equipment by yourself!

Technical Specifications

Model	H7-CO ₂	Sensor parameters	T/H	Temperature Range: -9-50°C(0-122°F)
Size	97mm(DIA)×39mm(W)		Pro-professional Model	Humidity Range: 0-99%RH
Net Weight	123g (without battery)	Standard Model	Operating Environment	CO ₂ Range: 0-10000 ppm
	153g (with battery)			CO ₂ Accuracy: ±(50+3%×Reading) ppm
Battery	Battery Capacity: 1600mAh	Operating Environment		CO ₂ Range: 400-5000 ppm
	Input Current: 5V / 2A			CO ₂ Accuracy: ±(50+5%×Reading) ppm
	Operating Time: 6-7hours			Operating Temperature: 0-50°C
	Charging time: about 2.5h			Operating Humidity: 15-80%RH

After-sales Service and Warranty Card

- Implement the national policy of Three Guarantees.
- Free maintenance will be provided by AVICHE in case of quality problems within one year from the date of purchase. In case of such issue over one year, the user can seek services by right of invoice and warranty card to the after-sales service departments, branch offices and distributors of AVICHE, where the spare parts for maintenance will be provided with reasonable charges. If the user can not provide invoice, the warranty period will be identified by extension of 13 months from the date of production.
- The followings are not covered by the warranty:
 - The Vulnerable Consumables.
 - The liquid leaked by the users enters into the device to cause abnormal operation.
 - The trouble caused by unauthorized demolition, repair, or transformation of the device.
 - The trouble caused by accidental falling down in use or handling.
 - The trouble caused by not following the correct method in the user manual.
 - Device damage caused by unforeseen natural disasters (such as fire, earthquake, flood, etc.).

AVICHE		Air Quality Monitor		Warranty Card	
Model	H7-CO ₂	Warranty	Valid Before ____Month ____Day ____Year		
Purchaser		Address		Name	
Seller		Address		Name	
After-sales Service Instructions	1. Warranty ① Since the date of purchase, the warranty period will last for 1 year, and free maintenance will be provided (except for force majeure and human factors). ② The affiliated gifts will not be covered within the warranty. ③ Proof: Purchase records or Invoice. 2. Spare Parts: Spare parts will be provided free of charge within the warranty period, and is subject to charges out of warranty period. 3. Contact Information for After-sales Service Service Hotline: +86-400-800-9850				

AVICHE Shandong Medical Technology Co., Ltd

AVICHE remains the right to change the technology and appearance of the products and is subject to change without prior notice. Thanks for the understanding.

Product Inspection Certificate

Product Name: Air Quality Monitor
 Model No: H7-CO₂
 Inspection Date: _____
 Quality Controller: _____

AVICHE

Manufacturer: AVICHE Shandong Medical Technology Co., Ltd.
Address: Building D1-1, Yinfeng Biological City Industrial Park, No.1177 Chunlan Road, High-tech Zone, Jinan City, Shandong Province, China.250104
Service Hotline: +86-400-800-9850
Website: www.aviche.cn
E-mail: info@aviche.com

Product Parts Introduction



Front View of Air Quality Monitor

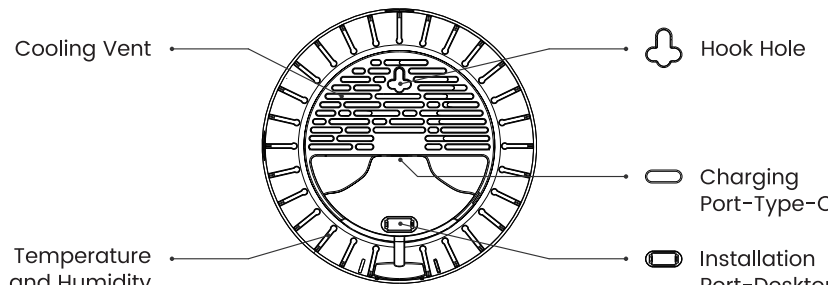

Rear View of Air Quality Monitor

Figure 2 Product Parts Introduction

Quick Use Guide

1. Screen Display

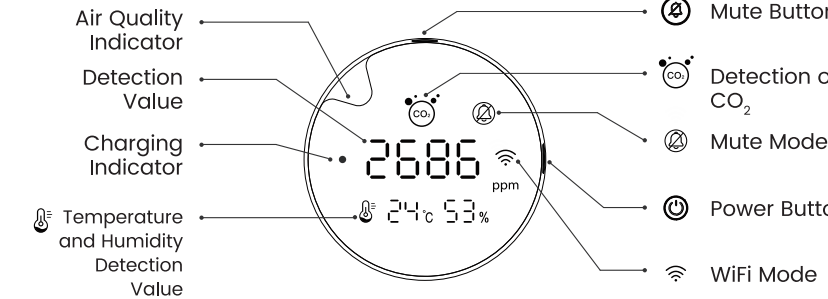
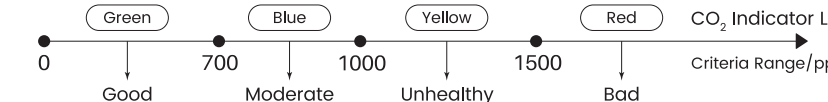

Figure 3 Display Screen of Air Quality Monitor

2. Operating Instructions

(1) Air Quality Indicator



(2) Charging Indicator

The red light is on when charging, and the indicator light is off when the power is full.

(3) Temperature and Humidity Monitoring Value

Digital display for ambient temperature and humidity detection. The temperature is expressed in degrees Celsius (°C) or Fahrenheit (°F).

(4) Mute Button

① When the alarm sounds, short press to turn off the alarm and the "Mute

Quick Use Guide

3. Introduction of device distribution network

② Long press in the startup state to enter the distribution network state to connect the "TuyaSmart" intelligent App.

(5) CO₂ Detection Value Real time display of detection value of CO₂ in the environment.

(6) Power Button Press the power button to turn on or turn off the device.

(7) WiFi Mode The icon is always on, indicating that the distribution network is successful; The icon flashes to show that it is in the process of distribution network; If the distribution network is not successful, the icon does not light up.

(8) Mute Mode Press the power button to turn on or turn off the device.

(9) Power Button Press the power button to turn on or turn off the device.

(10) WiFi Mode The icon is always on, indicating that the distribution network is successful; The icon flashes to show that it is in the process of distribution network; If the distribution network is not successful, the icon does not light up.

(11) WiFi Mode The icon is always on, indicating that the distribution network is successful; The icon flashes to show that it is in the process of distribution network; If the distribution network is not successful, the icon does not light up.

(12) WiFi Mode The icon is always on, indicating that the distribution network is successful; The icon flashes to show that it is in the process of distribution network; If the distribution network is not successful, the icon does not light up.

(13) WiFi Mode The icon is always on, indicating that the distribution network is successful; The icon flashes to show that it is in the process of distribution network; If the distribution network is not successful, the icon does not light up.

(14) WiFi Mode The icon is always on, indicating that the distribution network is successful; The icon flashes to show that it is in the process of distribution network; If the distribution network is not successful, the icon does not light up.

(15) WiFi Mode The icon is always on, indicating that the distribution network is successful; The icon flashes to show that it is in the process of distribution network; If the distribution network is not successful, the icon does not light up.

(16) WiFi Mode The icon is always on, indicating that the distribution network is successful; The icon flashes to show that it is in the process of distribution network; If the distribution network is not successful, the icon does not light up.

(17) WiFi Mode The icon is always on, indicating that the distribution network is successful; The icon flashes to show that it is in the process of distribution network; If the distribution network is not successful, the icon does not light up.



H7- CO₂

Quick Use Guide

4. Sound alarm description

(1) When the measured CO₂ value exceeds 1500ppm, the product will give an alarm sound of "drop drop drop".

(2) Turn off the sound alarm

① When the measured value of the product exceed the alarm value and give an alarm sound, short press the mute button on the top of the product to turn off the sound alarm. (if the measured value return below the alarm value and exceed the alarm value again, the product will still give an sound alarm.)

② The function of sound alarm can be turned off in App. After this function is turned off, the product will not give sound alarm again.

(3) Turn off the sound alarm

(4) Turn off the sound alarm

(5) Turn off the sound alarm

(6) Turn off the sound alarm

(7) Turn off the sound alarm

(8) Turn off the sound alarm

(9) Turn off the sound alarm

(10) Turn off the sound alarm

(11) Turn off the sound alarm

(12) Turn off the sound alarm

Quick Use Guide

(1) Wall Installation

Scheme I : Installation with expansion nut

① First, drill a 25mm deep hole at the wall hanging position with a 4mm Diameter drill bit, place the expansion nut into the hole position, align the reserved hole position of the wall hanging buckle with the expansion nut, insert the self-tapping screws, and tighten it clockwise to complete the installation of the wall hanging buckle.

*Note: Two holes are reserved for wall hanging buckle accessories. Users can install 1-2 expansion nuts on the wall for fixation according to the actual installation needs.

② After the product hook hole is aligned with the wall hanging buckle and inserted, gently pull the product in the vertical direction to complete the wall hanging installation.

③ After the product hook hole is aligned with the wall hanging buckle and inserted, gently pull the product in the vertical direction to complete the wall hanging installation.

④ After the product hook hole is aligned with the wall hanging buckle and inserted, gently pull the product in the vertical direction to complete the wall hanging installation.

⑤ After the product hook hole is aligned with the wall hanging buckle and inserted, gently pull the product in the vertical direction to complete the wall hanging installation.

⑥ After the product hook hole is aligned with the wall hanging buckle and inserted, gently pull the product in the vertical direction to complete the wall hanging installation.

⑦ After the product hook hole is aligned with the wall hanging buckle and inserted, gently pull the product in the vertical direction to complete the wall hanging installation.

⑧ After the product hook hole is aligned with the wall hanging buckle and inserted, gently pull the product in the vertical direction to complete the wall hanging installation.

⑨ After the product hook hole is aligned with the wall hanging buckle and inserted, gently pull the product in the vertical direction to complete the wall hanging installation.

⑩ After the product hook hole is aligned with the wall hanging buckle and inserted, gently pull the product in the vertical direction to complete the wall hanging installation.

⑪ After the product hook hole is aligned with the wall hanging buckle and inserted, gently pull the product in the vertical direction to complete the wall hanging installation.

⑫ After the product hook hole is aligned with the wall hanging buckle and inserted, gently pull the product in the vertical direction to complete the wall hanging installation.

⑬ After the product hook hole is aligned with the wall hanging buckle and inserted, gently pull the product in the vertical direction to complete the wall hanging installation.

Quick Use Guide

Scheme II : Installation with traceless adhesive tap

① Paste one side of the traceless adhesive tap on the back of the wall hanging buckle and the other side on the wall, and fix the wall hanging buckle on the wall.

② After the product hook hole is aligned with the wall hanging buckle and inserted, gently pull the product in the vertical direction to complete the wall hanging installation.

③ After the product hook hole is aligned with the wall hanging buckle and inserted, gently pull the product in the vertical direction to complete the wall hanging installation.

④ After the product hook hole is aligned with the wall hanging buckle and inserted, gently pull the product in the vertical direction to complete the wall hanging installation.

⑤ After the product hook hole is aligned with the wall hanging buckle and inserted, gently pull the product in the vertical direction to complete the wall hanging installation.

⑥ After the product hook hole is aligned with the wall hanging buckle and inserted, gently pull the product in the vertical direction to complete the wall hanging installation.

⑦ After the product hook hole is aligned with the wall hanging buckle and inserted, gently pull the product in the vertical direction to complete the wall hanging installation.

⑧ After the product hook hole is aligned with the wall hanging buckle and inserted, gently pull the product in the vertical direction to complete the wall hanging installation.

⑨ After the product hook hole is aligned with the wall hanging buckle and inserted, gently pull the product in the vertical direction to complete the wall hanging installation.

⑩ After the product hook hole is aligned with the wall hanging buckle and inserted, gently pull the product in the vertical direction to complete the wall hanging installation.

⑪ After the product hook hole is aligned with the wall hanging buckle and inserted, gently pull the product in the vertical direction to complete the wall hanging installation.

⑫ After the product hook hole is aligned with the wall hanging buckle and inserted, gently pull the product in the vertical direction to complete the wall hanging installation.

⑬ After the product hook hole is aligned with the wall hanging buckle and inserted, gently pull the product in the vertical direction to complete the wall hanging installation.

⑭ After the product hook hole is aligned with the wall hanging buckle and inserted, gently pull the product in the vertical direction to complete the wall hanging installation.

⑮ After the product hook hole is aligned with the wall hanging buckle and inserted, gently pull the product in the vertical direction to complete the wall hanging installation.

Figure 6 Installation Scheme with Traceless Adhesive Tap

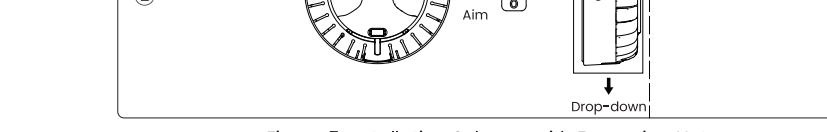
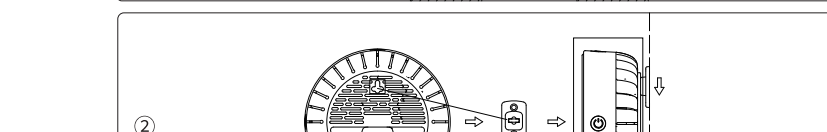
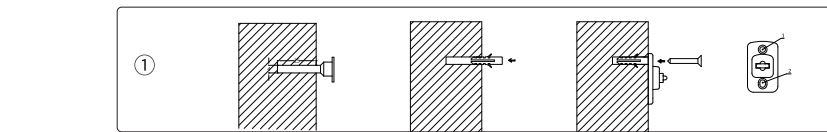

Figure 5 Installation Scheme with Expansion Nut

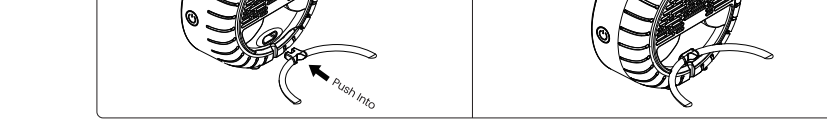
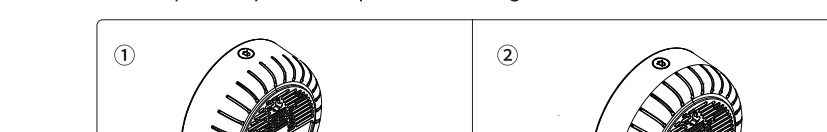

Figure 4 Installation Scheme with Desktop Holder